



# LANDSCAPE®

Old world craftsmanship. . tomorrow's technology®

## CAST Engineered Wall Light Surface Mount (CEWL6CB, CEWL6LED1) Product Information

*CAST Surface Mount Engineered Wall Light - Enhance your Outdoor Living Space*

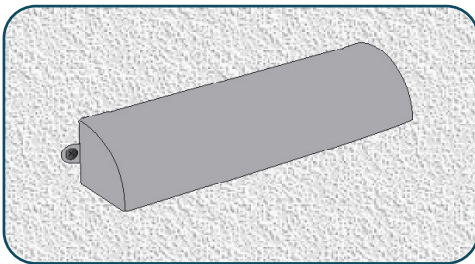
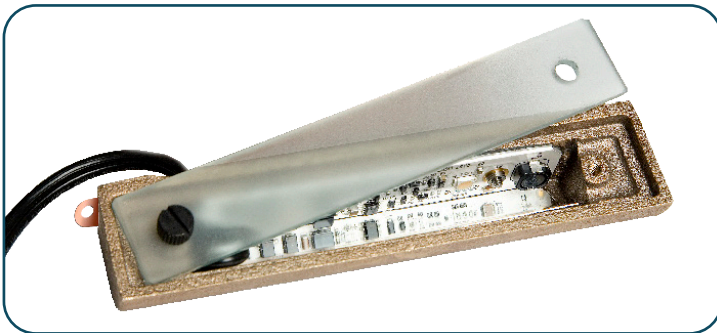

Rock-solid construction with a water-resistant 60,500-hr LED light source.

Typical mounting application on wall.

### Description:

Attractive wall light constructed of solid bronze with copper tabs for surface mounting.

LED version hosts a fully integrated LED source with constant current driver and excellent thermal management. LED board is rated for 60,500 hrs. with minimal lumen degradation.

### Features:

- Solid bronze construction, highly corrosion resistant, naturally weathers to a beautiful patina.
- Solid copper bracket for quick installation in a variety of locations.
- Enclosed LED housing includes internal reflector and frosted glass lens for wide even light distribution (no hot spots).
- Lamps protected from sprinklers and rain
- Pre-wired with 25' tin-coated No-Ox® marine grade wire.
- CEWL6CB: Includes 2.5W T5 LED Lamp (SL921T5200L)

### Uses:

Suitable for applications where a flush-mounted fixture is required. Ideal for walls, stairwells, and railings.

### Construction:

Solid bronze body, copper bracket, frosted soda lime lens, stainless steel thumbscrews, high temperature socket, 25' tin-coated #18-2 No-Ox® marine-grade wire.

### Specifications:

CEWL6CB: Includes 2.5W, 9-15V operating range, T5 LED Lamp (SL921T5200L).

Halogen Option: 12V, 10W, T3 halogen lamp - 18W max. (CWB1210X).

CEWL6LED1: 2 Cree LED's, 10-24V AC or DC, .24 Amps, 2.5W, .88PF, 2.84VA, 81 CRI, 2704°K Color Temp., L-70: 60,500, 76 Lumens, Center Beam Candela: 38

### Dimensions:

